

Teeth Bleaching System

MD-666
User manual



Teeth Bleaching System
MD-666

Catalogue

1. Safety..... 2

2. Assembly Instruction Illustration..... 3

3. Product Features..... 8

4. Product Specification..... 8

5. Content..... 9

6. Operation..... 9

7. Remote control manual..... 10

8. Liability..... 11

Safety

PLEASE NOTE

Prior to installation and start-up of the unit, carefully read the instructions provided herein. As with all technical devices, the proper function and safe operation of this unit depend on the user's compliance with the safety recommendations presented in these operating instructions.

 CAUTION: It is important to observe the following precautions and procedures:

Do not shine the light directly onto or toward unprotected gingival or skin.

 CAUTION: Persons with a history of photosensitivity or who are using photosensitizing

drugs should not be exposed to light from this unit.

 CAUTION: This equipment is not suitable for use in the presence of flammable anesthetic

mixtures with air or nitrous oxide.

 CAUTION: Please do not look into emitted light by the machine when it is in use

or it will hurt your eyes. Please be sure to wear goggles.

 CAUTION: The angle of bend in use please do not exceed 180 degrees, or easily

broken elbow, it may cause noise in the future.

声音提示

- a) 启动后，每按按键一次“滴”一声提示音。
- b) 启动后，运行至最后一分钟时，会有“滴”一声提示音。
- c) 完成后会有长“滴”一声提示音。

冷却设置

- a) 为了保证LED灯在美白过程中能够在正常温度下工作，内置一个高效率无噪音风扇，有助于散热
- b) 另内置有智慧型温度保护器，温度遇高时自动断电关机，等冷却后，一切又可正常工作。

可靠性

组装操作,延伸,重新调整,修改,维修都由我公司权威认可的人执行.
 请遵从电子产品安装室的相关要求.
 请按照说明进行使用.

Assembly Instruction Illustration

(1)

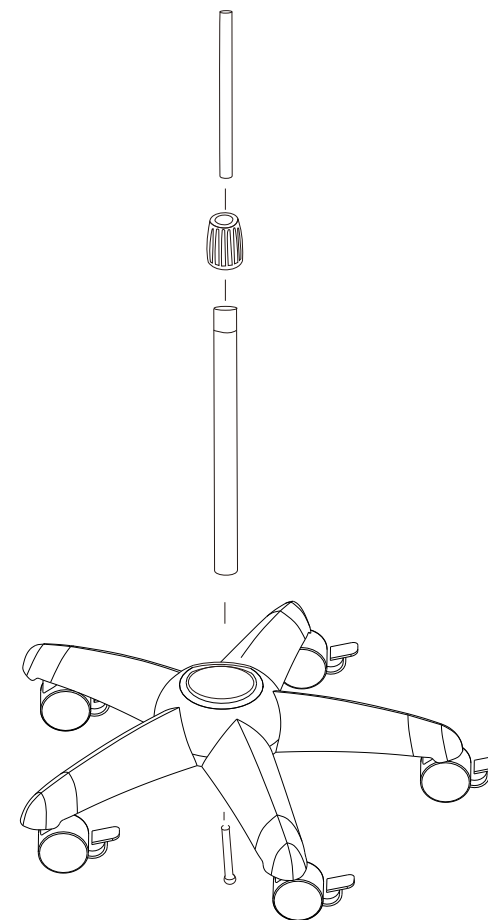

Warning:
 When this screw is loose, the spring will be come out

Assembly Instruction Illustration

(2)

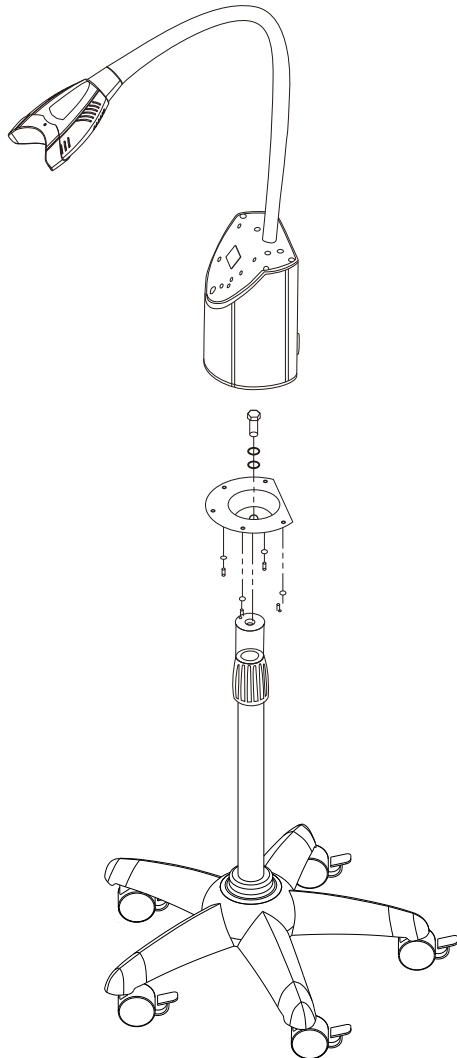

遥控器说明

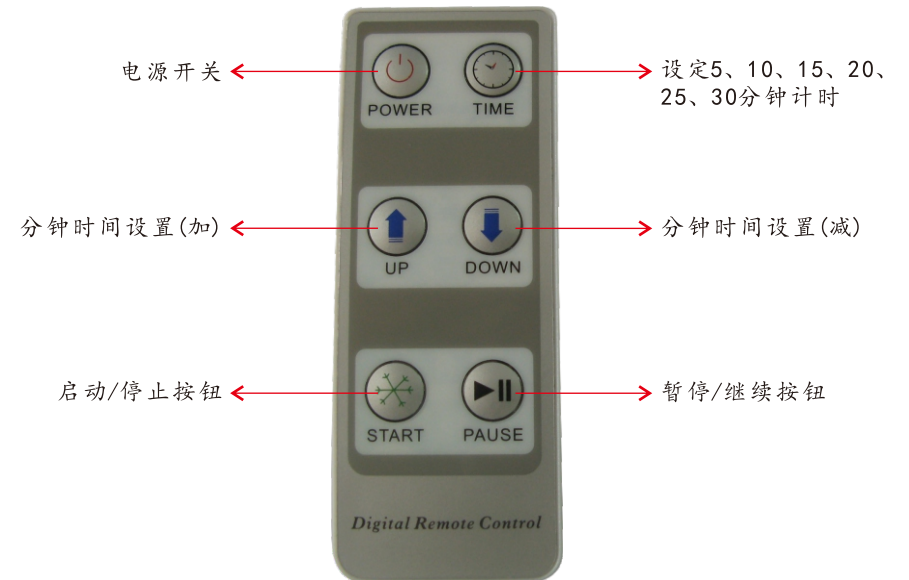

配件

MD-666	1台
电源线	1条(2米)
护目镜	2副
护套	20个
张口器	1个
遥控器	1个
使用说明书	1本

操作

打开牙齿美白仪的电源

- A. 接好电源线，接通电源
- B. 开启美白仪电源开关.

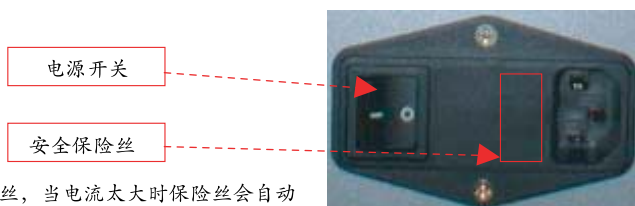

内置安全保险丝，当电流太大时保险丝会自动断开，换上新的保险丝后，一切又可以正常工作

牙齿美白仪操作:

- A. 电源按钮:通过按"START/STOP" 按钮开启和关闭电源.
- B. 暂停按钮:按下PAUSE 按钮将会停止时间统计和发出灯光,剩下的美白时间将会在数码指示灯上闪光.
- C. 设置按钮:使用"UP" /"DOWN" 按钮设置美白时间:5分钟开始统计,最长的美白时间是30分钟每轮.

Assembly Instruction Illustration



1. Twist the wheels to the feet, and twist tightly with a wrench

(1)



2 . Fix 5 feet onto the settled seat.

(2)

Assembly Instruction Illustration



3.Fixed tray aim at settled seat screw holes, and fix screws.

(3)



4.Put pole 1 with decorative set placed on the settled seat and support with hand.

(4)

产品特征

- 高性能的鹅管设计, 可任意调整角度, 使用起来更方便.
- 由高能量蓝灯组成.
- 事先设定的定时器由微处理器控制可调整美白时间.
- 数位指示灯带有声音反馈.
- 智能自动选择电压:100-240V 50/60 Hz 全世界可用.
- 小底座设计,方便在牙科诊所使用.
- 灯光输出高度统一性.
- 有高感度红外线摇控设定功能
- 附有一次性护套, 可防止交叉感染, 方便卫生, 让患者放心

产品规格

- 光波范围: 420nm~500nm (主灯)
- 灯光输出能量: 达到2000mW每平方厘米
- 电压: 100/240V, 50/60Hz
- 重量: 4.7Kg
- 最大的工作半径范围: 50厘米
- 灯光输出的高度统一性:

牙齿和操作板的距离	统一性
10mm	大于95%
20mm	大于90%
30mm	大于85%
40mm	大于80%
50mm	大于75%

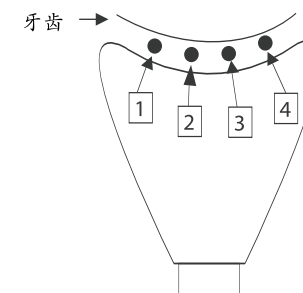

安装示意图

Assembly Instruction Illustration



5. 将脚架反过
来，用长螺丝将
固定座与立柱固
定（如果螺丝没
有扭紧，会造成
立柱摇晃）



5. Turn over the feet and fix settled
seat and pole with long screw.
(if the screw haven't twist tightly,
the pole will shake)

(5)

(5)



6. 将立柱2放入立
柱1并扭紧螺母

(6)



6. Put pole 2 into pole 1 and
twist nut tightly.

(6)

Product Features

- High efficiency goose pipe design, adjust angle at random, convenient for use.
- Combination of high power BLUE led.
- Tunable bleaching time with microprocessor-controlled timer presets.
- Digital indicator with audio feedback.
- Smart auto-select power: 100 to 240 Volts AC.50/60 Hz for global use.
- High Speed Multi-Arch Teeth Whitening System.
- Small base size design, suitable use in dental clinic
- High Uniformity of Light Output
- High sensitive infrared remote control setting function.
- Enclosed disposable sheath, prevent cross- infection, clean and convenient, let patient feel relieved.

Product Specifications

- Broad Spectrum: 420nm~500nm(Host Lamps)
- Light Output Power: Up to 2000 mW/cm²
- 100/240 Volt, 50/60Hz
- Weight: 4.7Kg
- Max. Working Radius: 50cm
- High Uniformity Of Light Output:

Distance between Teeth and Illuminator(mm)	Uniformity (Point 1to Point 5)
10mm	Above95%
20mm	Above90%
30mm	Above85%
40mm	Above80%
50mm	Above75%

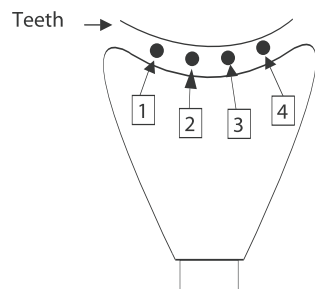

安装示意图



3. 将固定盘对准固定座上的螺丝孔，并用螺丝固定。

(3)



4. 将立柱1与装饰套放于固定座上，扶稳。

(4)

安装示意图



1. 将轮子扭到脚架上，并用扳手扭紧。

(1)



2. 将五个脚扣于固定座上。

(2)

Content

MD-666	x 1 PC
Power Cord	x 1 PC
Glass	x 2 pairs
Sheath	x 20 PCS
Mouth retractor	x 1 PC
Remote control	x 1 PC
User manual	x 1 PC

Operation

Turn on the Teeth Whitening Accelerator:

- a.) Plug in the Teeth Whitening Accelerator.
- b.) Turn on the power switch

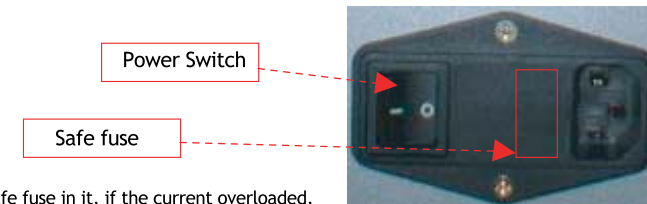

We fixed safe fuse in it, if the current overloaded, it will cut off immediately, when you change new fuse, everything will work smoothly as usual

Operating the Teeth Whitening Accelerator:

- a.) **Start/stop Button:** Turn on/off the light by pressing the "Start/stop" button
- b.) **Pause Button:** Stop the time counting and emitting light by pressing the "Pause" button.
The remaining whitening time will sparkle on the digital indicator .
Press the "Pause" button again, light will emit and time will count continually
- c.) **UP/Down Button:** Use "UP" or "Down" button to set whitening time.
5 minutes counting with memory, the longest whitening time is 30 minutes each cycle



Remote control manual

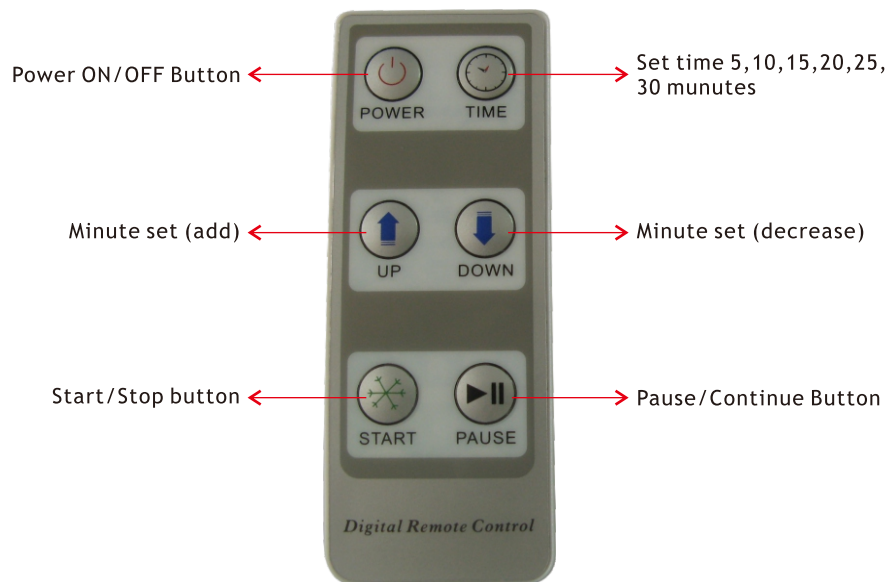

安装示意图

(2)

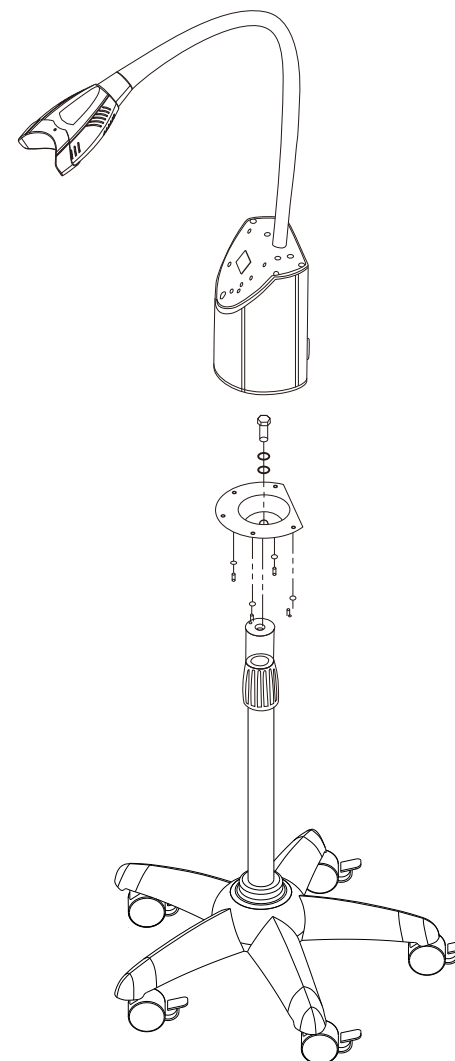

安装示意图

(1)

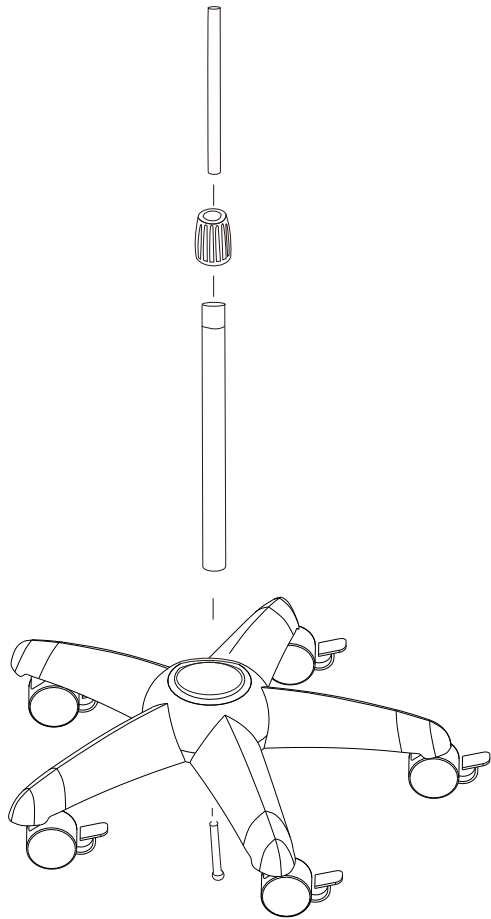

警告：
安装时请注意锁紧螺丝，否则弹簧会弹出。

Sound Instruction

- a). After starting, once the button is pressed, a beep sounds.
- b). After starting, when running to the last minute, there will be a beep sound.
- c). After completion, there will be a long beep.

Cooling Setting

- a.) To guarantee all LEDs could work at the normal temperature when whitening process, we fix a high efficiency and quite fan to expel *Heat*.
- b.) Besides, we built-in smart temperature protection, when it meets high temperature will shut down power automatically, after cooling, all can work properly.

Liability

It is responsible for the effects on safety, reliability and performance of this product only if:

- The electrical installation of the relevant room complies with the requirements.
- The equipment is used in accordance with these instructions for use.

目录

1. 安全注意事项	2
2. 安装示意图	3
3. 产品特征	8
4. 产品规格	8
5. 配件	9
6. 操作	9
7. 遥控说明	10
8. 可靠性	11

安全注意事项

注意:

在安装和启动此设备之前,请仔细阅读说明

在操作说明中请注意以下的安全使用建议.

 警告:遵守以下的预防措施和步骤是非常重要的.

 警告:对感光度敏感的人或是使用过感光药物的人不要使用该设备.

 警告:此设备不适合放在带有可燃性的酒精混合物或是氮氧化物环境中.

 警告:请不要直视这个仪器发出的灯光,否则造成眼睛伤害,使用中请切记带护目镜.

 警告:使用时弯管的角度请不要超过 180° ,否则弯管容易折断,将来可能造成噪音出现.